



NIRALA  
ASP|RE  
NOIDA EXTENSION

**Aspire For More Get Even More**



**ASPIRE A BLOSSOM OF  
ELOQUENT DESIGN GRAMMAR**



**LEGEND**

- 1. MAIN ENTRANCE
- 2. WATER CASCADE
- 3. SOCCER YARD
- 4. CLUB
- 5. GYM
- 6. SPA (TUB, SAUNA, BATH HOUSE)
- 7. RESTAURANT
- 8. MULTIPURPOSE HALL
- 9. RECEPTION
- 10. TABLE TENNIS
- 11. GARDEN
- 12. GOLF COURSE
- 13. SWIMMING POOL
- 14. TENNIS COURT
- 15. TENNIS COURT
- 16. CRICKET PITCH
- 17. BASKETBALL COURT
- 18. BASKETBALL COURT
- 19. BASKETBALL COURT
- 20. SKATING RING
- 21. AMPHITHEATRE
- 22. CENTRAL LAWN
- 23. STREAM
- 24. TREASURY GARDEN
- 25. ROCK GARDEN
- 26. FLOWER GARDEN
- 27. PAVILION
- 28. BOWLING COURT
- 29. JOGGING TRACK
- 30. WOODEN BRIDGE
- 31. BARBEQUE COURT
- 32. PALM COURT
- 33. COMMERCIAL - STORE DEPARTMENT

**BLOCK LEGEND**

A1-A2-B1-B2 (20+M)	= 4800 x 3700 x 3SERVANT	
A3-A4-A5-A6-B3-B4-B5 (20+M)	= 3810 x 2700 x 3SERVANT	
	3810 x 2700 x 2SERVANT (LARGE)	
A6-A7-A8-B7-B8-B9 (20+M)	= 3810 x 2700 x 3SERVANT	
C1-C2-C3-C4-C5-C6 (20+M)	= 2980 x 2700 x 3SERVANT	
D1-D2-D3-D4-D5-D6 (20+M)	= 2980 x 2700 x 3SERVANT	
	2980 x 2700	

**THE ELITE FLOOR PLANS FOR  
THE MAXIMUM COMFORT**

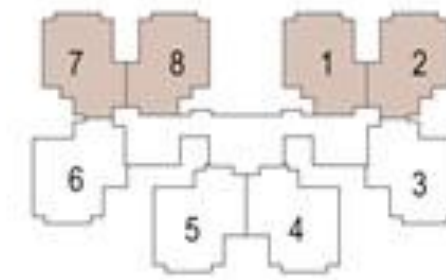

**KEY PLAN**

SALEBLE AREA - 885 SQ.FT.

C-2, C-3, D-1, D-2,  
(G+ 14)

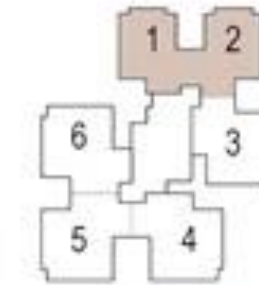

C-1 & D-3,  
(G+ 14)

**2 BED + 2 TOI**



**2 BED + 2 TOI  
+ STUDY**

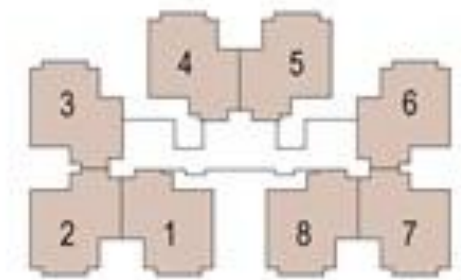

**KEY PLAN**

SALEBLE AREA - 1170 SQFT

C-5&D-5  
(G+14)

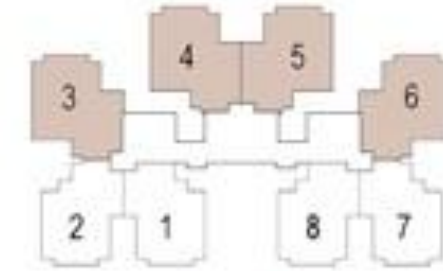

C-2, C-3, D-1, D-2,  
(G+14)

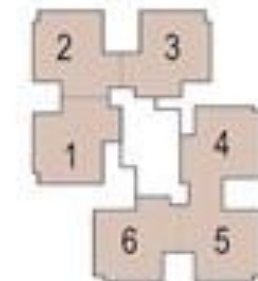

C-4, C-6, D-4 & D-6,  
(G+14)

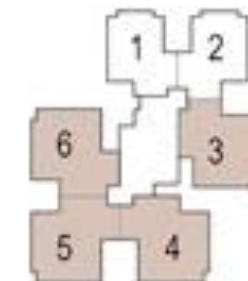

C-1 & D-3,  
(G+14)





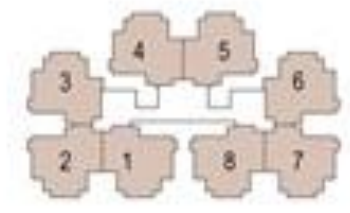

KEY PLAN  
 SALEBLE AREA - 1366 SQFT.  
 A-6, A-7, A-8, B-2, B-3, B-4  
 (G+14)

**3 BED + 2 TOI  
 + DRESS**

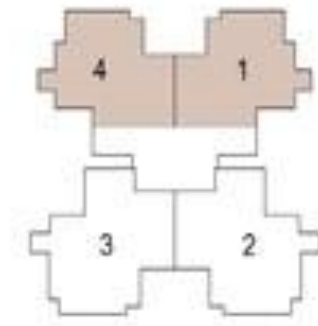

**KEY PLAN**  
 SALEBLE AREA - 1457 SQFT.  
 A-3, A-4, A-5, B-5, B-6, B-7  
 (G+14)

**3 BED + 2 TOI  
 + DRESS**

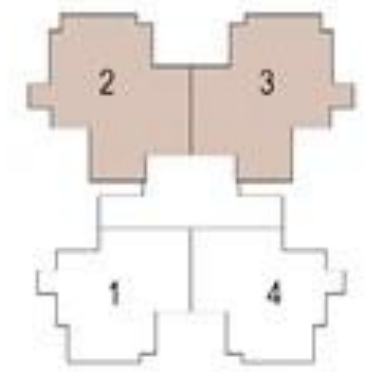

**KEY PLAN**  
 SALEBLE AREA - 1711 SQ.FT.  
 A-3, A-4, A-5, B-5, B-6, B-7  
 (G+ 14)

**3 BED + 3 TOI  
 + SER/STUDY**

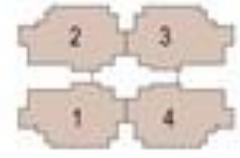

KEY PLAN

SALEABLE AREA - 2418 SQFT.

A-1, A-2, B-1 & B-2  
(G+18)

**4 BED + 4 TOI + SER**



**PLUSH, LUSH AND AWAY  
FROM THE MADDING RUSH**

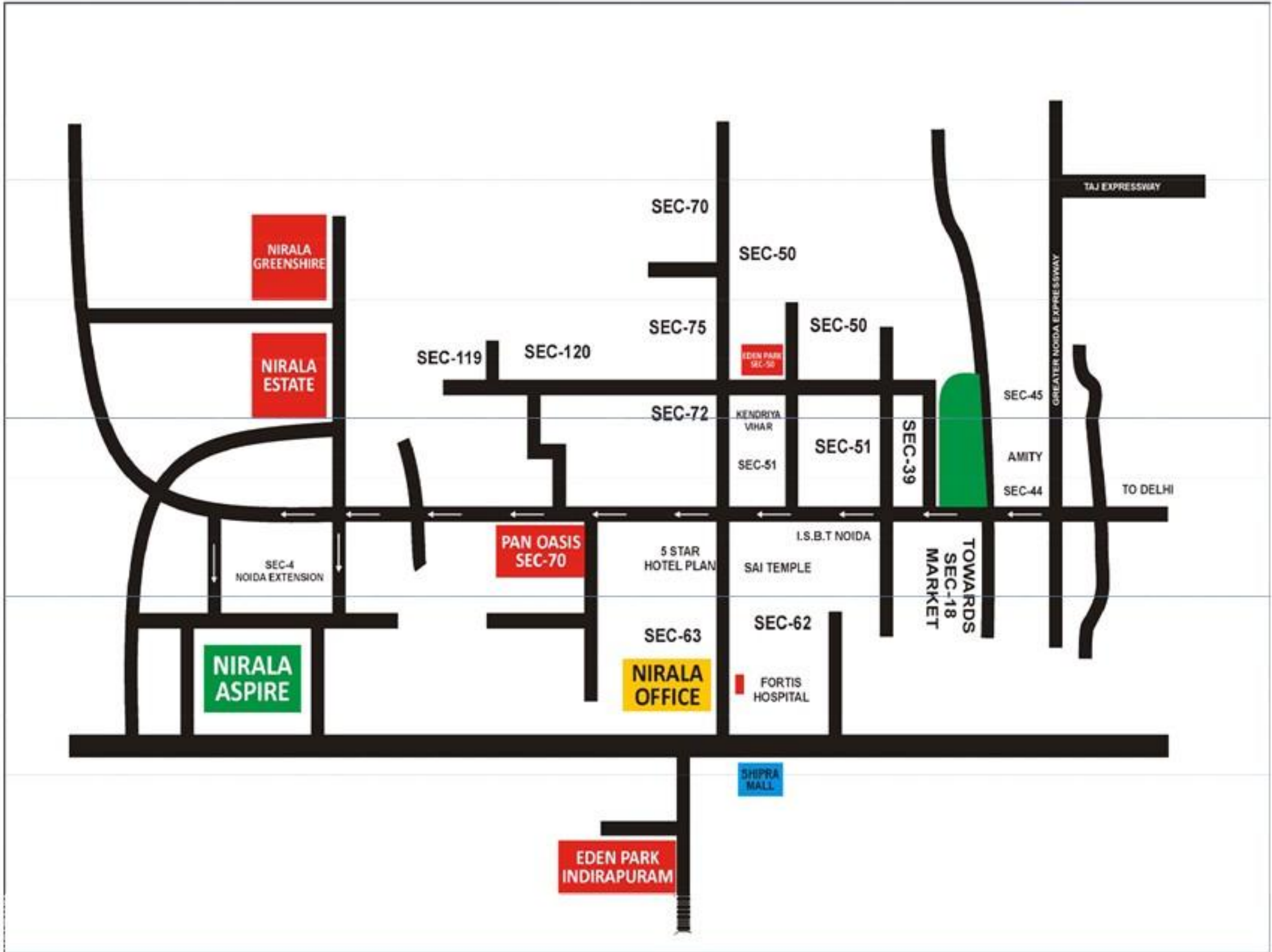

**EVERYTHING YOU DESIRE IS  
JUST A WALK AWAY**

## **PLACE**

- **DND Flyover**
- **Amity**
- **Golf Course**
- **Sect-18 & Atta Market**
- **Metro Station**
- **Fortis Hospital**
- **Sai Dhama**

## **DRIVE AWAY Distance / Time**

- **20 Minutes.**
- **15 Minutes**
- **10 to 15 Minutes.**
- **15 minutes**
- **8 minutes.**
- **8 minutes**
- **5 minutes**



**THANK YOU**

